

MONUMENT RECORD
State of Indiana - County of Monroe

Section: 7

Township: 8 North

Range: 1 East

Corner ID: SaCr A-07

Monument Description & Remarks: Limestone with "X", length 0.32ft, width 0.42ft, height 0.53ft. Survey Sign 3.5ft above ground at pt. B

References On File: Eric Lee Deckard survey, Moravec Boundary (2001), on file in Auditor Office and Surveyor Office

RECOVERY TIE DRAWING
Field Book 39 Page No. 74

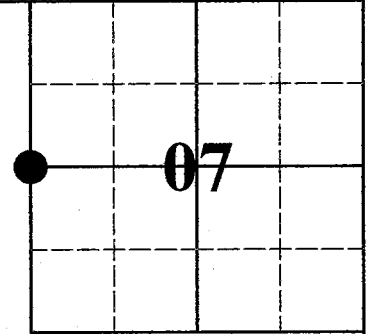
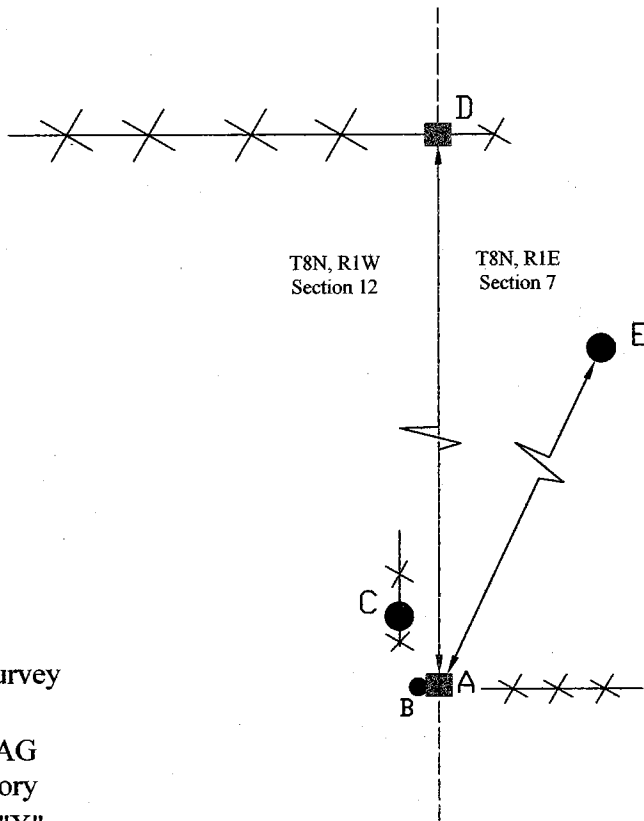

- A - Limestone
- B - N 70° W 0.36' to Survey Sign on metal post
- C - N 04° E 2.30' to MAG nail in 10" Pignut Hickory
- D - N 04° E 177.40' to "X" in Sandstone, (Per Y-07)
- E - N 35° E 105.33' to MAG nail in 24" Sugar Maple

Not To Scale
Compass Bearing Magnetic North

I, Kevin P. Enright, Monroe County Surveyor, hereby certify that this document was prepared under my direction in accordance with the provisions of ~~section 36-2-12-11~~ of the Indiana Code; and the above data is given under my hand and seal this 28th day of September, 2007.

Kevin P. Enright



Administered by the Monroe County Surveyor & Review Board

Date: 11-13-2007